

GRAND BALLROOM LOWER LOBBY

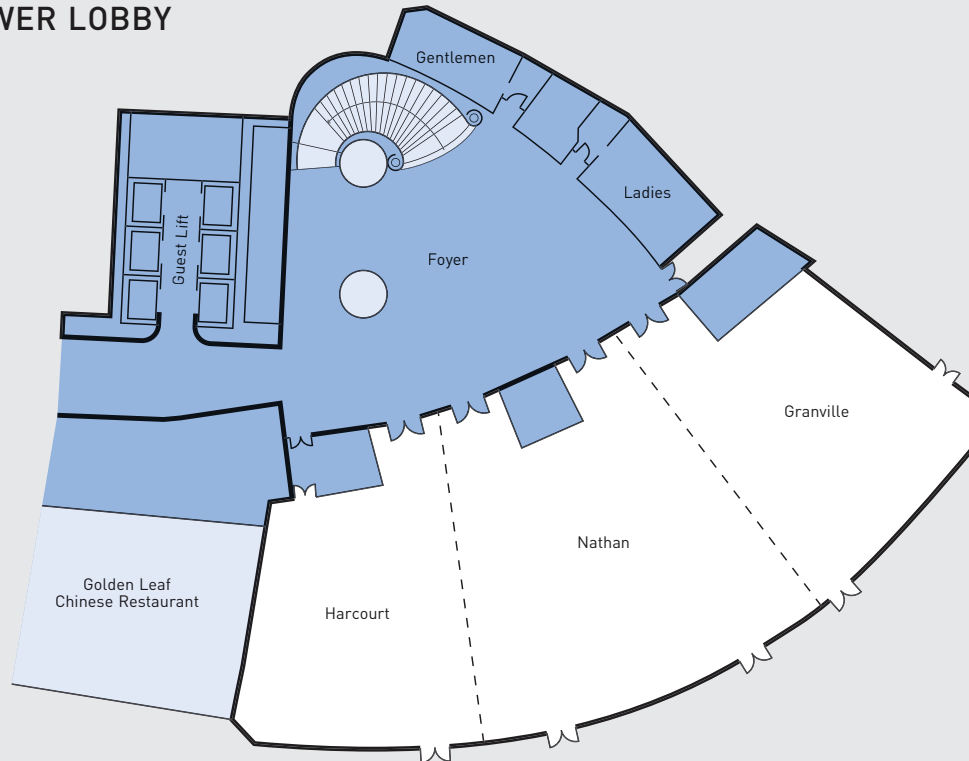

Room	Area		Dimensions		Height		Capacities					
	Sq m	Sq ft	Metres	Feet	Metres	Feet	Classroom	Theatre	Banquet	Reception	Dinner/Dance	U-shape
Grand Ballroom	767	8,242	21 x 53.5	64' x 162'	4.5	15'	400	700	624	1000	516	90
Granville	231	2,484	21 x 14.2	63' x 43'	4.5	15'	84	200	132	250	96	40
Nathan	311	3,344	21 x 21	64' x 64'	4.5	15'	124	300	180	400	144	48
Harcourt	225	2,414	21 x 14.2	63' x 43'	4.5	15'	84	200	132	250	96	40
Nathan + Granville	542	5,828	21 x 31	63' x 93'	4.5	15'	208	500	384	650	312	78
Harcourt + Nathan	536	5,758	21 x 31	63' x 93'	4.5	15'	208	500	384	650	312	78
Meeting Rooms												
Chatham	158	1,700	14.2 x 15.52	43' x 47'	2.8	9'2"	88	180	108	180	-	36
Hennessy	144	1,549	10.2 x 14.9	31' x 45'	2.8	9'2"	72	150	96	150	-	35
Stanley	38	404	5 x 9	15' x 27'	2.8	9'2"	16	24	24	30	-	12
Salisbury	38	404	5 x 9	15' x 27'	2.8	9'2"	16	24	24	30	-	12
Tai Tam	38	404	5 x 9	15' x 27'	2.8	9'2"	16	24	24	30	-	12
Humphrey	38	404	5 x 9	15' x 27'	2.8	9'2"	16	24	24	30	-	12
Bowen	91	980	13.5 x 7.6	41' x 23'	2.4	8'	48	80	72	80	-	30
Kennedy	54	580	7.6 x 7.6	23' x 23'	2.4	8'	24	45	48	45	-	17
Caine	51	550	8.9 x 7.6	27' x 23'	2.4	8'	24	40	36	40	-	17
Barker	29	315	4.6 x 6	14' x 18'	2.5	8'2"	12	15	12	20	-	10
Robinson	17	180	5 x 3.3	15' x 10'	2.4	8'	8 (Boardroom)					